

# MC-GP/GE

## Special Grippers • Miniature Grippers



### Weight

0.022 kg .. 0.066 kg  
0.78 oz .. 2.33 oz

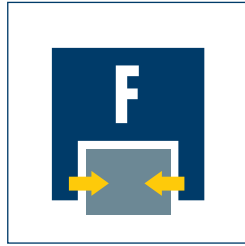

### Gripping force

0.15 N  
0.034 lbf



### Stroke per finger

2.2 mm  
0.087 in



### Workpiece weight

0.003 kg  
0.11 oz

## Application example

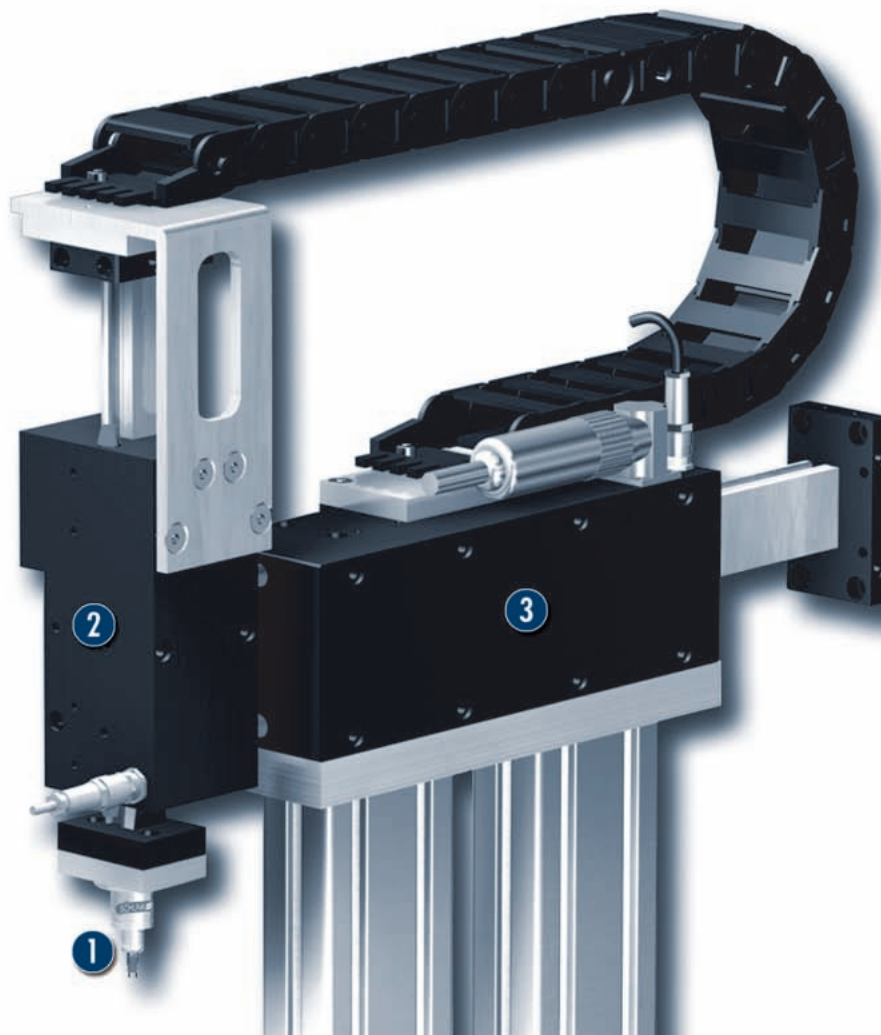

Pick & place unit for assembling circuit boards with capacitors

- 1** MC-GE 005 Miniature Centric Gripper
- 2** Servo-electric Short-stroke Module with MLD 50K direct drive
- 3** Servo-electric Linear Axis with MLD 100 direct drive

### Miniature Gripper

Single-acting miniature gripper with electric or pneumatic drive and spring return

### Area of application

Grips the smallest workpieces in clean to low-soiling environments, such as in assembly lines and laboratories

### Your advantages and benefits

#### Simple, fast drive kinematics

for short cycle times and high cycle frequencies

#### Integrated stroke adjustment

for optimum adaptation to different workpieces

#### Flexible fingers

for gripping sensitive or asymmetrical components

#### Small, compact design

for minimal interfering contours and low weight



### General information on the series

#### Working principle

Single-acting, spring return via fingers

#### Housing material

Aluminum

#### Actuation

Electric, 24 VDC, or pneumatic

#### Warranty

24 months

#### Scope of delivery

Gripper with mounted finger guard, assembly and operating manual with manufacturer's declaration

#### Maintenance

Maintenance-free

#### Accessories

The MC-GE or MC-GP is also available on request as a 2-finger parallel gripper.



### Technical data

Description		MC-GP 005
	ID	0305600
Max. stroke per finger	mm [in]	2.2 [0.087]
Gripping force	N [lbf]	0.15 [0.034]
Weight	kg [oz]	0.022 [0.78]
Recommended workpiece weight (max.)	kg [oz]	0.003 [0.11]
Minimum pressure	bar [psi]	2.0 [29]
Maximum pressure	bar [psi]	7.0 [102]
Closing time at max. stroke	s	0.05
Opening time at max. stroke	s	0.04
Smallest gripping Ø	mm [in]	0.6 [0.024]
Largest gripping Ø	mm [in]	5.0 [0.197]
Min. ambient temperature	°C [°F]	5.0 [41]
Max. ambient temperature	°C [°F]	55.0 [131]
Repeat accuracy	mm [in]	0.1 [0.0039]

### Main views

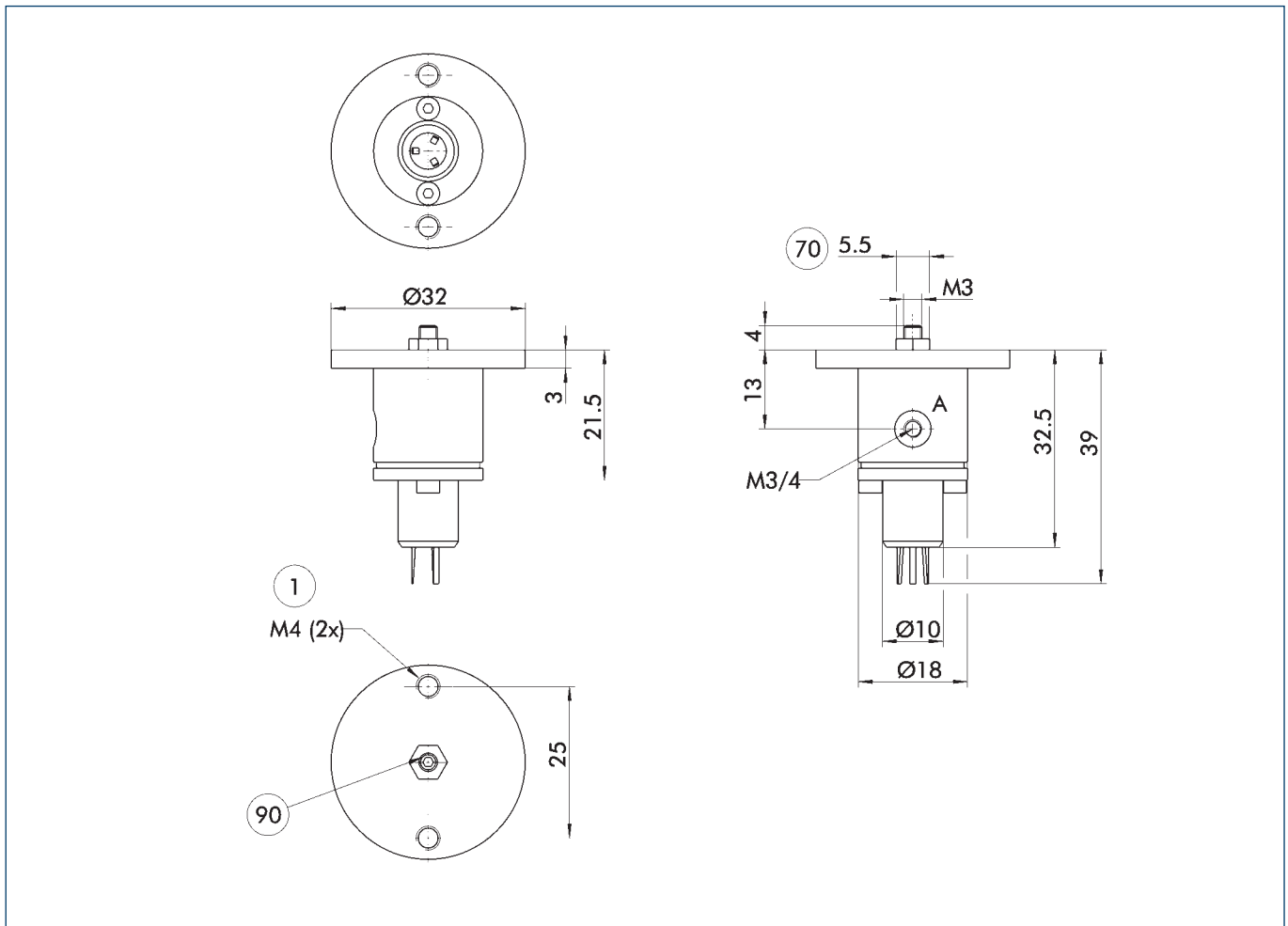

The drawing shows the gripper in the basic position with open fingers.

- A,a Main/direct connection, gripper opening
- ① Gripper connection
- 70 Width across flats
- 90 Preset gripper diameter

### FME finger module

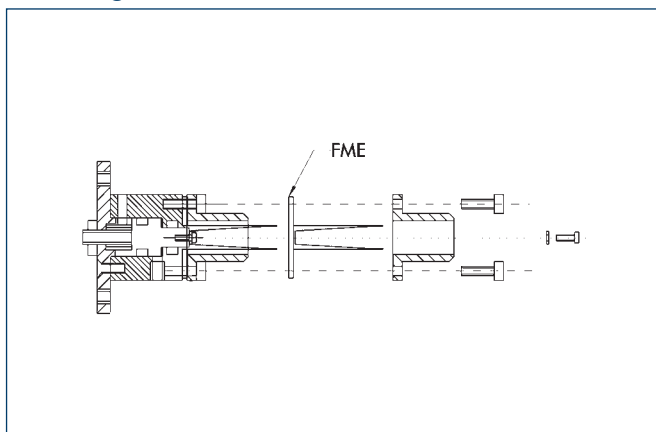

If a finger is damaged, it suffices to simply replace the FME finger module.

Description	ID
FME	0305603