

### Nutensteine

Vergütet und präzisionsgeschliffen  
einschließlich Zylinderschrauben, DIN 912-12.9  
Typen: FN-T, NK und NS

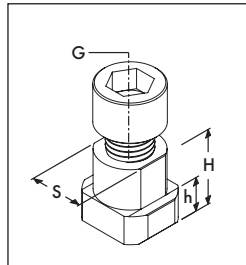

Ausführung I / Version I

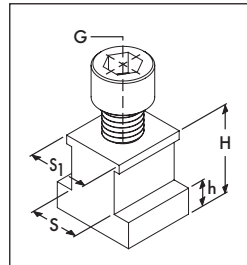

Ausführung II / Version II

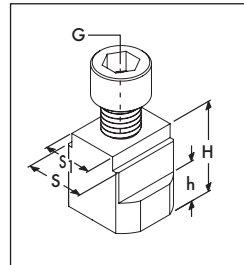

Ausführung III / Version III

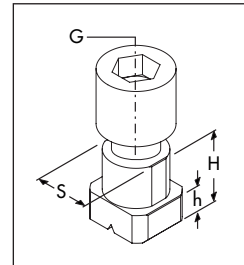

Ausführung IV / Version IV

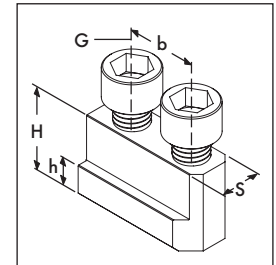

Ausführung V / Version V

### T-Nuts

Tempered and precision ground  
including screws, DIN 912-12.9  
Types: FN-T, NK and NS

FORKARDT-FUTTERTYPE FORKARDT CHUCK TYPE	SCHUNK-Type	Ident-Nr. Id.-No.	Ausf. Version	S/S <sub>1g6</sub>	H	h	b	Gewinde Thread	Zyl.-Schraube DIN 912 Cyl.-Screw DIN 912	Max. zul. Anzieh- drehmoment Nm Max. adm. tight- ening torque Nm
KTHS 130-140	FN-T 10	148 110	IV	12	17	7	–	M 10	(D 16 / SW 10)	40
KTHS 160-175	FN-T 12	148 111	IV	14	18.5	8	–	M 12	(D 18 / SW 12)	62
2BLE-PS 160-200; 2BLEF 200; KGH/KGHF 160-175; KL/KS 160; KSF 175; KSH/KSPS 160; KT/KTG/KTN 160; KTH 160-175; NH/NHF 160-175; QLC 160-175; QLK 160-175; UVE 160	NS 120	140 101	I	17	23	9	–	M 12	M 12 x 30	70
	NK 120	147 107	V	17	23	9	19	M 12	M 12 x 30	70
	NS 17/21	140 108	II	17/21	24	9	–	M 12	M 12 x 30	70
KG/KGH/KGHF 200; KL/KLNC/KP 200; KS/KSHF 200-250; KSF/KSH/KSPS 200; KT/KTH/KTG/KTGF/KTN 200; NH/NHF 200; QLC/QLK 200; QLC-KS/QLK-KS 200-250; KL/KS 250 (Monforts); NHF 250-290 (Index); UVE 200-250	NS 120	140 101	I	17	23	9	–	M 12	M 12 x 30	70
	NK 121	145 100	V	17	23	9	22	M 12	M 12 x 30	70
	NS 17/21	140 108	II	17/21	24	9	–	M 12	M 12 x 30	70
KTHS 200-250-315	FN-T 14	148 112	IV	17	23	9	–	M 14	(D 21 / SW 14)	90
2BLE 200-250 (Monforts); 2BLN 200; KG 250-315; KL 250; KLNC/KP 250-315; KS 315-400; KSH/KSHF 250-400; KSPS 250-300; KT/KTG/KTGF/KTN 250-315; NH/NHF 250-315; NHF 257-290; NHF 400 (Index); QLC/QLK 250-315; QLC-KS/QLK-KS 315-400; UVE 315	NS 160	140 102	I	21	27	11	–	M 16	M 16 x 35	150
	NK 160	145 101	V	21	27	11	28	M 16	M 16 x 35	150
	NS 21/17	140 122	III	21/17	27	11	–	M 12	M 12 x 30	70
2BLE 250-315; 2BLN 250-315; KG 400-500; KL/KLNC 400-500; KP 400-500; KS 500; KSH 500; KSPS 400; KT/KTGF 400-500; KTG/KTN 400-500; NH/NHF 400-500; QLC/QLK 400; UVE 400-500	NS 200	140 103	I	25.5	29	11	–	M 20	M 20 x 40	220
	NK 200	145 102	V	25.5	29	11	35	M 20	M 20 x 40	220
	NS 25.5/21	140 109	III	25.5/21	29	11	–	M 16	M 16 x 35	150
KS 630; KSHF 630; KS-L 630; KT/KTGF 630; NH/NHF 630; UVE 630-800	NK 200	145 102	V	25.5	29	11	35	M 20	M 20 x 40	220
KS 800-1000; KSF 1000	NS 240	140 104	I	30	41	15	–	M 24	M 24 x 50	450